

ORDINANCE NO. 45-1982

AN ORDINANCE PROVIDING FOR THE ABANDONMENT OF A PORTION OF PUBLIC RIGHT OF WAY; PROVIDING FOR THE TERMS AND CONDITIONS OF SUCH ABANDONMENT, AND CALLING A PUBLIC HEARING.

BE IT ORDAINED BY THE CITY COUNCIL OF THE CITY OF ABILENE, TEXAS:

PART 1: That the following described portion of a Public Right of Way, as described on Exhibit "A," attached hereto and made a part of this ordinance for all purposes, be, and the same is hereby abandoned, vacated and closed insofar as the right, title or easement of the public is concerned.

PART 2: That said portion of a Public Right of Way is not needed for public purposes and it is in the public interest of the City of Abilene to abandon said described portion of a Public Right of Way.

PART 3: That the abandonment provided for herein shall extend only to the public right, title and easement in and to the tracts of land described in Part 1 of this ordinance, and shall be construed only to that interest the governing body of the City of Abilene may legally and lawfully abandon.

PASSED ON FIRST READING this the 22 day of April, A.D. 19 82.

A notice of the time and place, where and when said ordinance would be given a public hearing and considered for final passage, was published in the Abilene Reporter-News, a daily newspaper, of general circulation in the City of Abilene, said publication being on the 5 day of April, 19 82, the same being more than twenty-four (24) hours prior to the time designated for said hearing. After such opportunity for the public to be heard, said ordinance was passed on second and final reading.

PASSED ON SECOND AND FINAL READING this the 6 day of May, A.D. 19 82.

(SEAL)
ATTEST:

Kelly Beard, Clerk
CITY SECRETARY

Kitty Webster
MAYOR Pro Tem

APPROVED:

Larry Sanders
CITY ATTORNEY

9.2.5

ORDINANCE NO. 45-1982

EXHIBIT "A"

Legal Description:

BEING 1531 square feet of land out of the J. Blakemore Survey No. 97, Abilene, Taylor County, Texas, and being more fully described by metes and bounds as follows:

BEGINNING at a point in the west boundary line of Ridgemont Drive, the original SE corner of Lot 2, Block "D", Section 1, Curry Park Addition, for the NE corner of this tract, from which the SE corner of the J. E. Shepherd Survey No. 96 bears S 0°19'25" E 30.0 feet and N 89°17'07" E 276.2 feet and the NW corner of the J. Blakemore Survey No. 97 and the SW corner of the J. Shepherd Survey No. 96 a point in the centerline of Elm Creek bears S 0°19'25" E 30.0 feet and S 89°17'07" W 8072.7 feet;

THENCE S 0°19'25" E 11.50 feet along the west boundary line of Ridgemont Drive to an iron rod, set in concrete, on the north boundary line of the proposed Rolling Green Drive, a 60 feet wide street;

THENCE S 89°17'07" E along the proposed Rolling Green Drive 50.20 feet to an iron rod, set in concrete, for a point for a curve to the right;

THENCE along said curve to the right having a property line radius of 676.36 feet, a chord of 124.72 feet, an arc length of 124.89 feet, and on a chord bearing of N 85°25'29" W to a point for the SW corner of this tract;

THENCE N 89°17'07" E 174.46 feet to the POINT OF BEGINNING, and containing 1531 square feet of land, more or less.

-END-

9-2-82

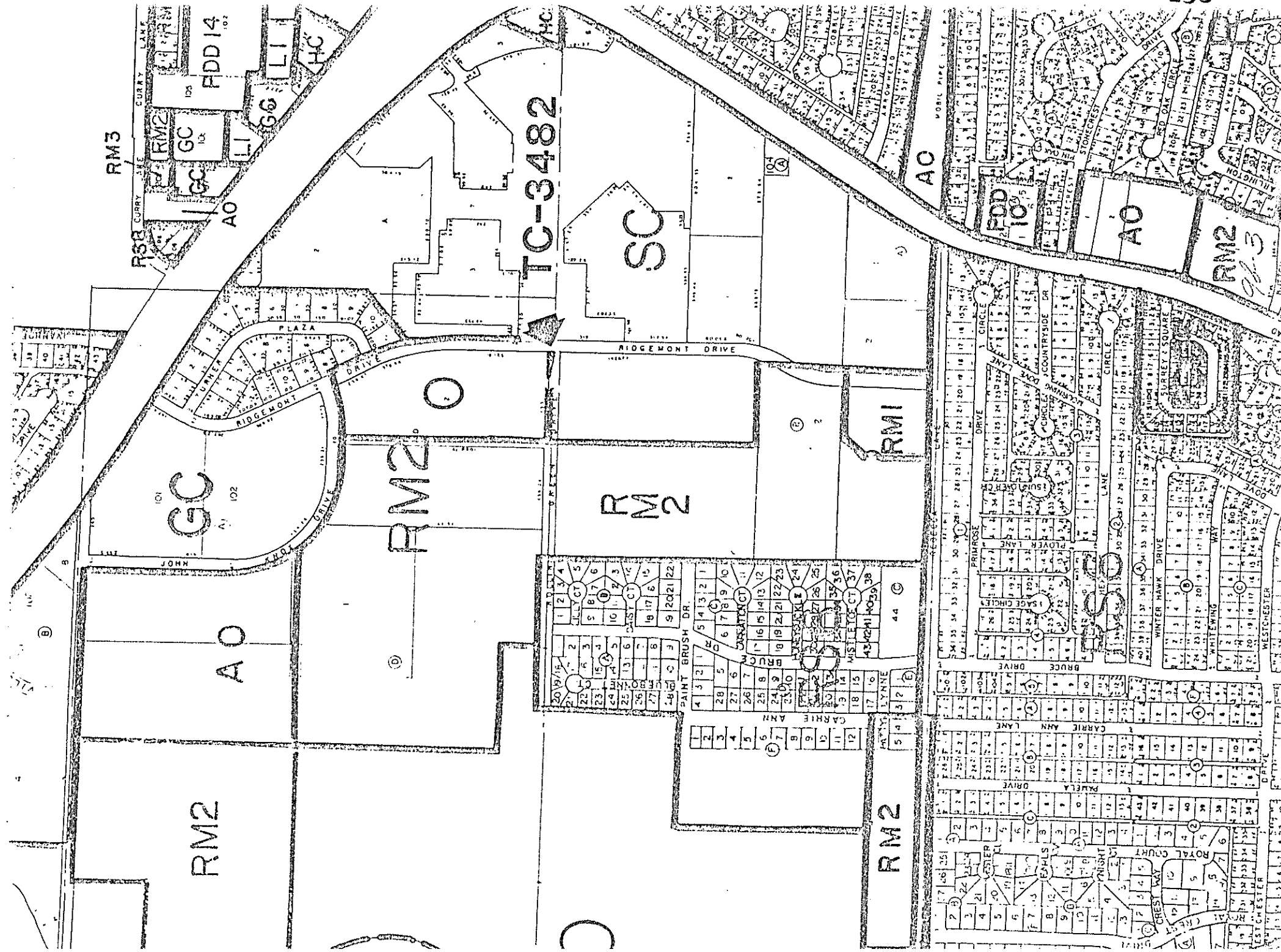

RM3

RM2

GC

LI

LI

LI

LI

LI

LI

LI

LI

LI

LI

LI

LI

LI

LI

LI

LI

LI

LI

LI

LI

LI

LI

R58

GC

GC

LI

LI

LI

LI

LI

LI

LI

LI

LI

LI

LI

TC-3482

LI

LI

LI

LI

LI

LI

LI

LI

LI

LI

AO

LI

LI

LI

LI

LI

LI

LI

LI

LI

LI

LI

LI

LI

LI

LI

LI

LI

LI

LI

LI

LI

LI

LI

GC

LI

LI

LI

LI

LI

LI

LI

LI

LI

LI

LI

LI

LI

LI

LI

LI

LI

LI

LI

LI

LI

LI

LI

GC

LI

LI

LI

LI

LI

LI

LI

LI

LI

LI

LI

LI

LI

LI

LI

LI

LI

LI

LI

LI

LI

LI

LI

GC

LI

LI

LI

LI

LI

LI

LI

LI

LI

LI

LI

LI

LI

LI

LI

LI

LI

LI

LI

LI

LI

LI

LI

GC

LI

LI

LI

LI

LI

LI

LI

LI

LI

LI

LI

LI

LI

LI

LI

LI

LI

LI

LI

LI

LI

LI

LI

GC

LI

LI

LI

LI

LI

LI

LI

LI

LI

LI

LI

LI

LI

LI

LI

LI

LI

LI

LI

LI

LI

LI

LI

GC

LI

LI

LI

LI

LI

LI

LI

LI

LI

LI

LI

LI

LI

LI

LI

LI

LI

LI

LI

LI

LI

LI

LI

GC

LI

LI

LI

LI

LI

LI

LI

LI

LI

LI

LI

LI

LI

LI

LI

LI

LI

LI

LI

LI

LI

LI

LI

GC

LI

LI

LI

LI

LI

LI

LI

LI

LI

LI

LI

LI

LI

LI

LI

LI

LI

LI

LI

LI

LI

LI

LI

GC

LI

LI

LI

LI

LI

LI

LI

LI

LI

LI

LI

LI

LI

LI

LI

LI

LI

LI

LI

LI

LI

LI

LI

GC

LI

LI

LI

LI

LI

LI

LI

LI

LI

LI

LI

LI

LI

LI

LI

LI

LI

LI

LI

LI

LI

LI

LI

GC

LI

LI

LI

LI

LI

LI

LI

LI

LI

LI

LI

LI

LI

LI

LI

LI

LI

LI

LI

LI

LI

LI

LI

GC

LI

LI

LI

LI

LI

LI

LI

LI

LI

LI

LI

LI

LI

LI

LI

LI

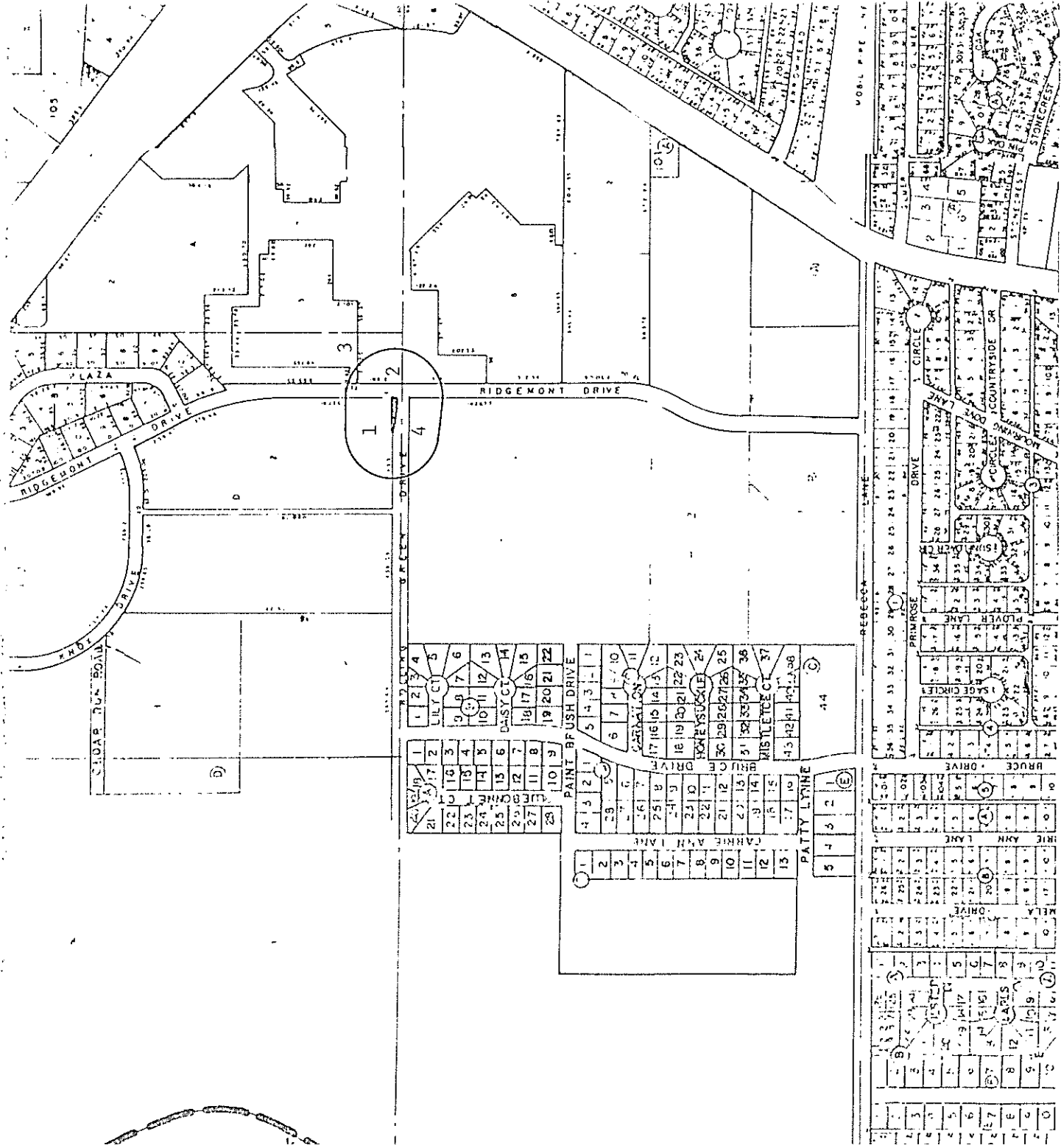

C-3482

1. C.K. Aneff Enterprises, Inc, 507 Citizens National Bank Bldg, 79601
2. Mall of Abilene, c/o Buddy Herring, 2212 B St, Meridian, MS, 39301
3. H.J. Wilson Co, Box 66221, Baton Rouge, LA, 70896
4. L.G. Rhodes, c/o Cullars & Bailey, Box 3193, 79604

92-1

THE STATE OF TEXAS I
COUNTY OF TAYLOR I
CITY OF ABILENE I

I, Kelly Beard, Assistant City Secretary of the City of Abilene, Texas, do hereby certify that the above and foregoing is a true and correct copy of an ordinance adopted by the City Council of the City of Abilene, Texas, on 6 day of May, A. D., 19 82, same being recorded in the Ordinance Records of the City of Abilene, Texas, Volume 2, Page 71.

Given under my hand and seal of office this the 6 day

 of May, A. D., 19 82.

Kelly Beard
Assistant City Secretary
City of Abilene, Texas