

ORDINANCE NO. 16-1983

AN ORDINANCE PROVIDING FOR THE ABANDONMENT OF A PORTION OF PUBLIC RIGHT OF WAY; PROVIDING FOR THE TERMS AND CONDITIONS OF SUCH ABANDONMENT, AND CALLING A PUBLIC HEARING.

3806

VOL 120 PAGE 218

BE IT ORDAINED BY THE CITY COUNCIL OF THE CITY OF ABILENE, TEXAS:

PART 1: That the following described portion of a Public Right of Way, as described on Exhibit "A," attached hereto and made a part of this ordinance for all purposes, be, and the same is hereby abandoned, vacated and closed insofar as the right, title or easement of the public is concerned.

PART 2: That said portion of a Public Right of Way is not needed for public purposes and it is in the public interest of the City of Abilene to abandon said described portion of a Public Right of Way.

PART 3: That the abandonment provided for herein shall extend only to the public right, title and easement in and to the tracts of land described in Part 1 of this ordinance, and shall be construed only to that interest the governing body of the City of Abilene may legally and lawfully abandon.

PASSED ON FIRST READING this the 10th day of February,
A. D. 19 83.

A notice of the time and place, where and when said ordinance would be given a public hearing and considered for final passage, was published in the Abilene Reporter-News, a daily newspaper, of general circulation in the City of Abilene, said publication being on the 6th day of February, 19 83, the same being more than twenty-four (24) hours prior to the time designated for said hearing. After such opportunity for the public to be heard, said ordinance was passed on second and final reading.

PASSED ON SECOND AND FINAL READING this the 24th day of February, A. D. 19 83.

ATTEST:

Shelley Board Assistant
CITY SECRETARY

Julius
MAYOR.

APPROVED:

Yvonne Sanders
CITY ATTORNEY

90-6

ORDINANCE NO. 16-1983

EXHIBIT "A"

Legal Description:

Being located between Simmons & Hickory and beginning at a point 155.8 feet south of Lowden and extending south for a distance of 221.75 feet and being 15.27' in width and being located between Lots 2 & 3 and 12 & 13, Block 13, North Park Addition, Abilene, Taylor County, Texas.

Location:

Between Simmons & Hickory and being south of Lowden.

-END-

90-7

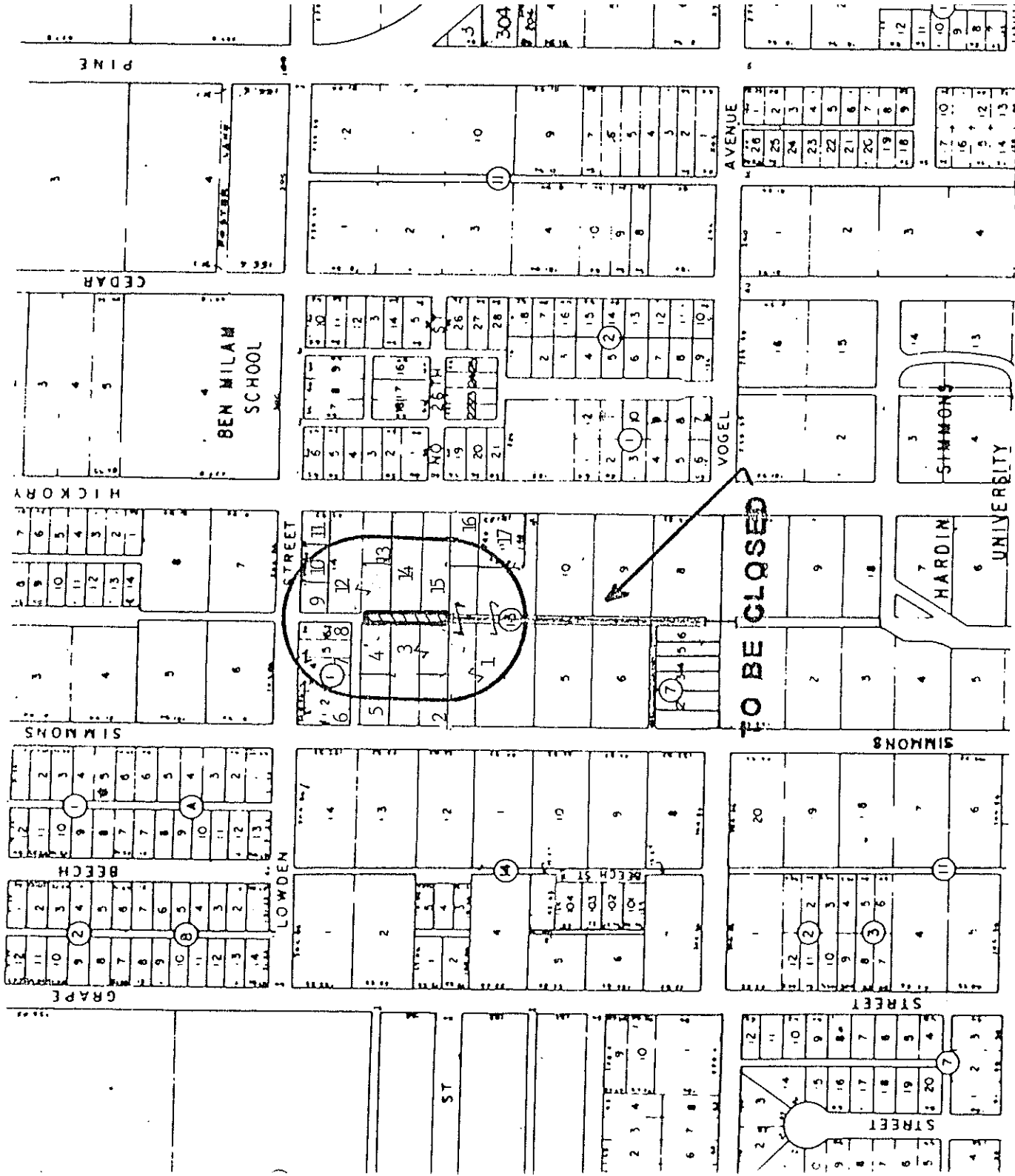

TC-0783

City of Abilene

1. Hardin-Simmons University, Drawer B, HSU Station, 79698
2. M.L. Richardson, 2617 Simmons, 79601
3. A. Hollar, 601 East 1st, Weatherford, 76086
4. J.E. Harvey, 2641 Simmons, 79601
5. J.R. Harvey, 2641 Simmons, 79601
6. C.W. Jones, 2665 Simmons, 79601
7. R.L. McClain, 1417 Lowden, 79601
8. Madge Bruce, P.O. Box 627, 79604
9. Faustino Trevino, 1341 Lowden, 79601
10. D.H. Buenrostro, 641 Hickory, 79601
11. Jmeyer Barbian, 1317 Lowden, 79601
12. L.C. Watson, c/o Jimmy Partin, 3434 N. 6th, 79603
13. Calvin Maxwell, 2626 Hickory, 79601
14. Mrs. Ethel A. Smith, 2602 Hickory, 79601
15. Hendrick Medical Foundation, Box 88, 79604
16. Manuel & Sarah Garcia, 2598 Hickory, 79601

90-3

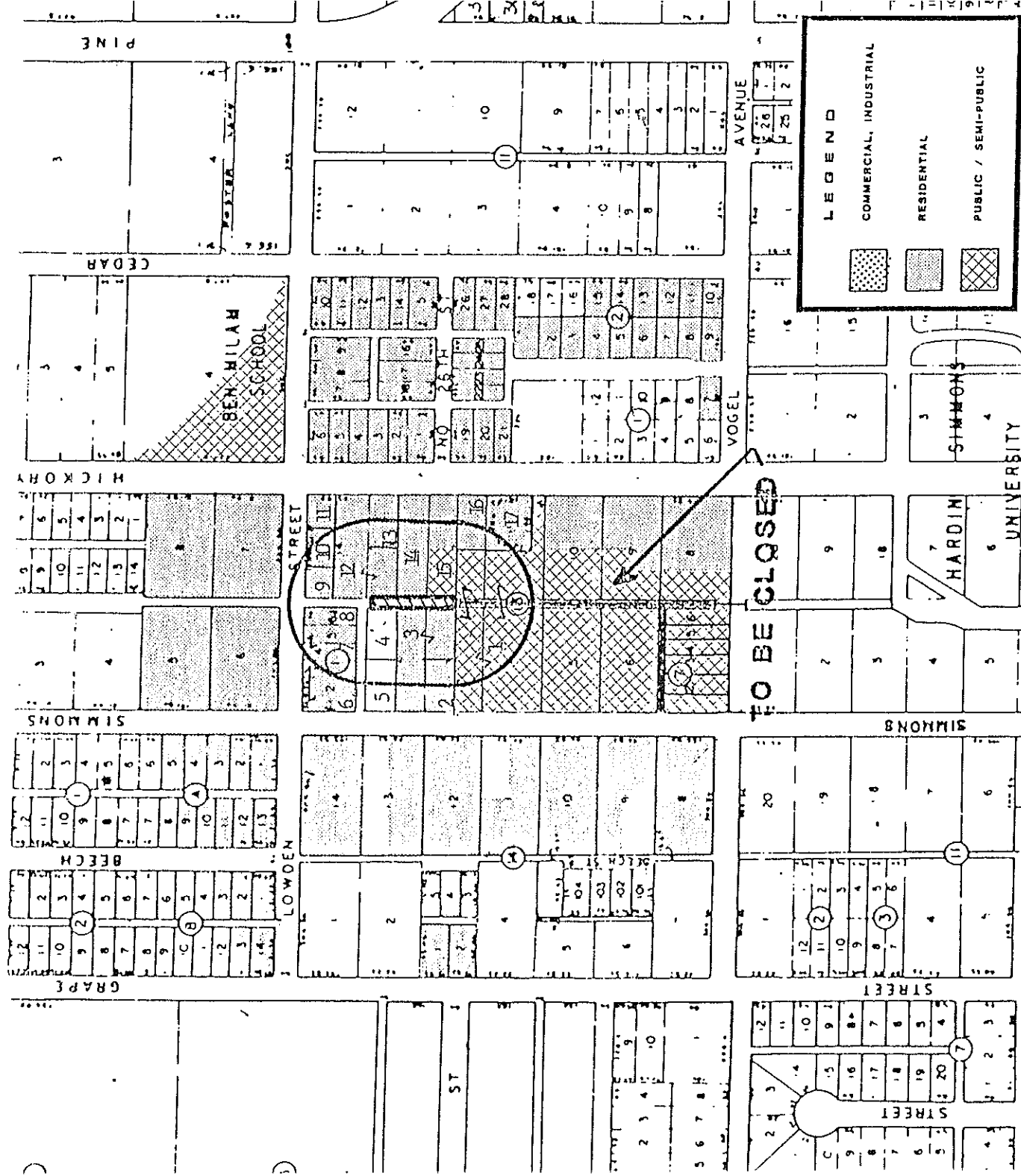

TC-0783

City of Abilene

1. Hardin-Simmons University, Drawer B, HSU Station, 79698
2. M.L. Richardson, 2617 Simmons, 79601
3. A. Hollar, 601 East 1st, Weatherford, 76086
4. J.E. Harvey, 2641 Simmons, 79601
5. J.R. Harvey, 2641 Simmons, 79601
6. C.W. Jones, 2665 Simmons, 79601
7. R.L. McClain, 1417 Lowden, 79604
8. Madge Bruce, P.O. Box 627, 79604
9. Faustino Trevino, 1341 Lowden, 79601
10. D.H. Buenrostro, 641 Hickory, 79601
11. Jmeyer Barbian, 1317 Lowden, 79601
12. L.C. Watson, c/o Jimmy Partin, 3434 N. 6th, 79603
13. Calvin Maxwell, 2626 Hickory, 79601
14. Mrs. Ethel A. Smith, 2602 Hickory, 79601
15. Hendrick Medical Foundation, Box 88, 79604
16. Manuel & Sarah Garcia, 2598 Hickory, 79601
17. Charley Dennis, 2490 Hickory, 79601

90-5