

AN ORDINANCE PROVIDING FOR THE ABANDONMENT OF A PORTION OF PUBLIC RIGHT OF WAY; PROVIDING FOR THE TERMS AND CONDITIONS OF SUCH ABANDONMENT, AND CALLING A PUBLIC HEARING.

BE IT ORDAINED BY THE CITY COUNCIL OF THE CITY OF ABILENE, TEXAS:

PART 1: That the following described portion of a Public Right-of-Way, as described on Exhibit "A," attached hereto and made a part of this ordinance for all purposes, be, and the same is hereby abandoned, vacated and closed insofar as the right, title or easement of the public is concerned, subject to conditions as stated in Exhibit A.

PART 2: That said portion of a Public Right-of-Way is not needed for public purposes and it is in the public interest of the City of Abilene to abandon said described portion of a Public Right-of-Way.

PART 3: That the abandonment provided for herein shall extend only to the public right, title and easement in and to the tracts of land described in Part 1 of this ordinance, and shall be construed only to that interest the governing body of the City of Abilene may legally and lawfully abandon.

PASSED ON FIRST READING this 25<sup>th</sup> day of January A.D. 2018.

A notice of the time and place, where and when said ordinance would be given a public hearing and considered for final passage, was published in the Abilene Reporter-News, a daily newspaper of general circulation in the City of Abilene, said publication being on the 15<sup>th</sup> day of December, 2017, the same being more than twenty-four (24) hours prior to the time designated for said hearing. After such opportunity for the public to be heard, said ordinance was passed on second and final reading.

PASSED ON FINAL READING THIS 8<sup>th</sup> day of February, A.D. 2018.

ATTEST:

  
\_\_\_\_\_  
CITY SECRETARY

  
\_\_\_\_\_  
MAYOR

APPROVED:  
  
\_\_\_\_\_  
CITY ATTORNEY



EXHIBIT "A"

The City of Abilene hereby abandons a portion of the west end of Ward Drive between Rivercrest Drive and Elm Creek. Ward Drive being a 50-foot right-of-way extending approximately 230'+/- west from the west line of right-of-way for Rivercrest Drive, and ending at Elm Creek.

All Public Right-of-Way as indicated and shown in the map below within the dashed area:

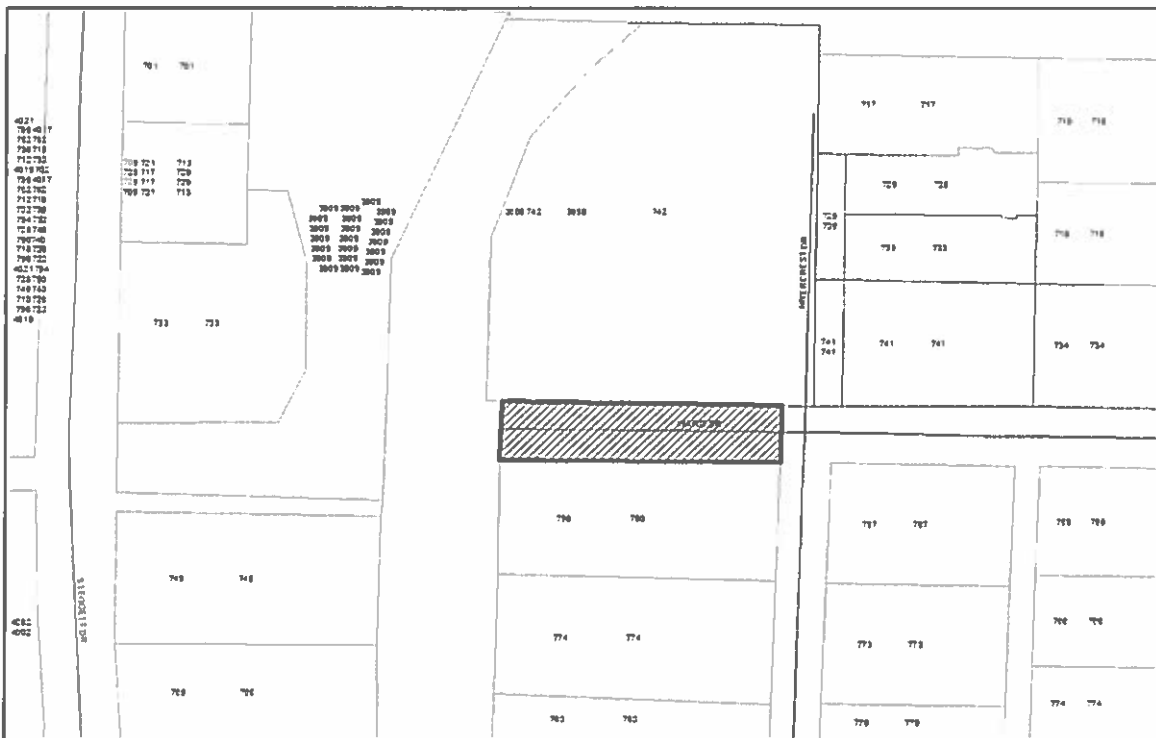

With the following conditions:

1. The applicant must replat within 12-months from the date of this ordinance, incorporating the entire right-of-way (authorized to be abandoned) into one or both adjoining properties.
2. The applicant is responsible for providing easements for and/or relocating any existing utilities.

-END-