

Resolution Authorizing The Abilene Medical and Surgical Building to Extend The Construction under The Sidewalk as Indicated on Plat Attached with Reservations Expressed Herein.  
\*\*\*\*\*

Whereas, owners of the proposed Abilene Medical and Surgical Building presented to the Board of Commissioners a plat approved by the City Engineer showing that a part of the basement is desired to extend under the sidewalk, said plat being hereto attached and made part hereof; and

Whereas, said owners agree to construct said portion of said basement under the supervision of the City Engineer and agree that in the event it shall ever become a detriment or interfere with the use of the sidewalk for the public or in any way damage same that the said construction will be removed and all damages paid, and agree further that the owners will hold the City ~~wholly~~ whole and secure from any damages by reason of such construction:

Now, Therefore, Be It Resolved By The Board of Commissioners of The City of Abilene, Texas that such construction and extension of the basement as shown on the plat attached and made part hereof, be permitted with the <sup>def</sup>standing that same will be removed whenever The City of Abilene through its governing body requests removal and that same shall be constructed under the supervision of the City Engineer, and that The City of Abilene is to be held harmless by reason of any damage to persons or property arising from such extension or the construction thereof.

Passed and approved this the 6th day of February 1931.

Tom S. Neapel MAYOR.

ATTEST:

Lucie Allen CITY SECRETARY.

Approved as to form before passage:

W. T. Beck  
Corporation Counsel.

PLAT SHOWING LOCATION OF PAVEMENT UNDER SIDEWALK AS PROPOSED  
UNDER PLANS FOR THE ABILENE MEDICAL AND SURGICAL CLINIC BLDG.

Abilene Texas,  
2-6-1931

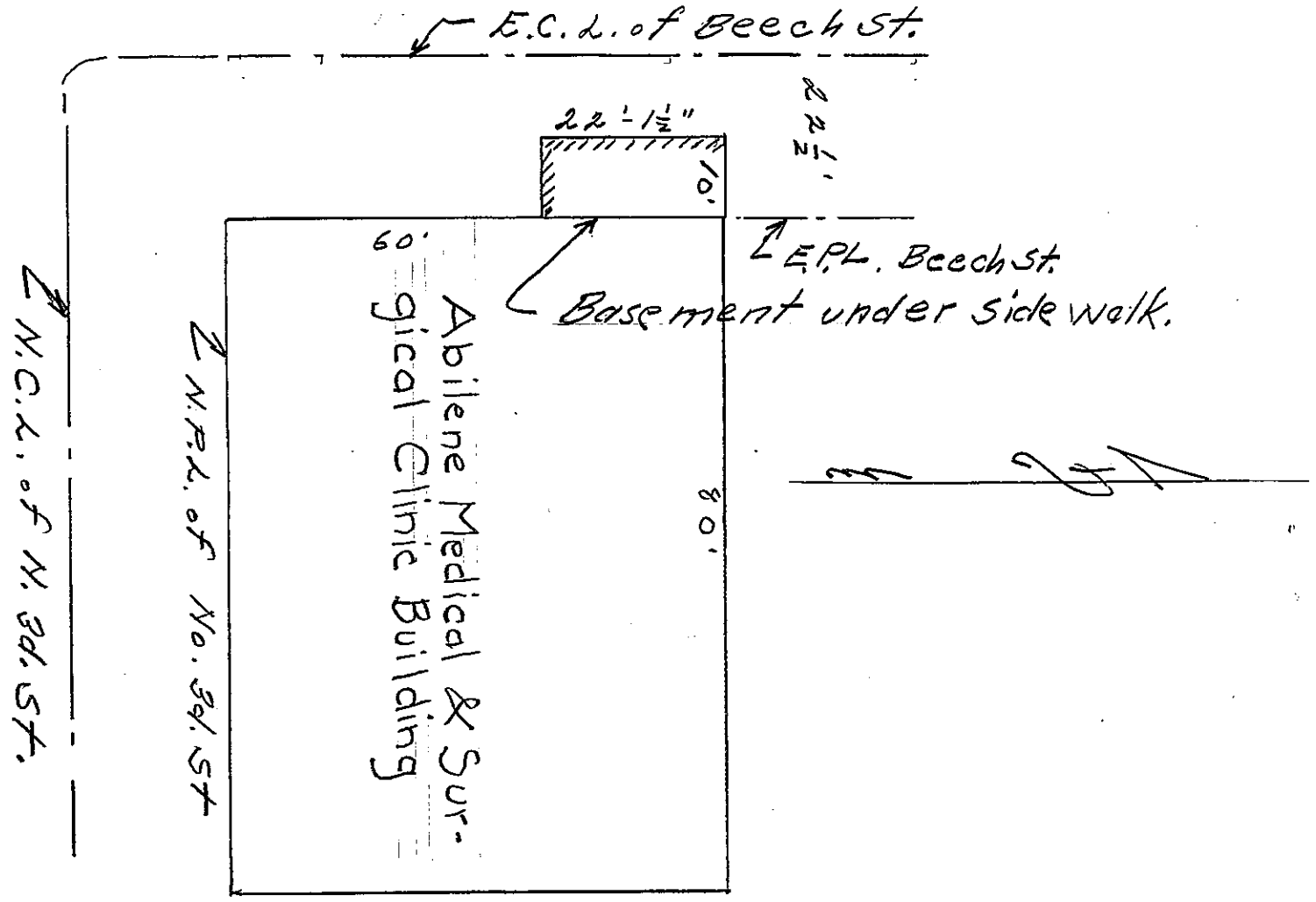

PLAT SHOWING LOCATION OF PAVEMENT UNDER SIDEWALK AS PROPOSED  
UNDER PLANS FOR THE ABILENE MEDICAL AND SURGICAL CLINIC BLDG.