

RESOLUTION NO. 40-1994

A RESOLUTION OF THE CITY COUNCIL OF THE CITY OF ABILENE, TEXAS, DIRECTING STAFF TO PREPARE A SERVICE PLAN FOR PROPOSED ANNEXATION OF CERTAIN PROPERTY.

WHEREAS, the City Staff has made recommendations concerning proposed annexation of property; and,

WHEREAS, it is the opinion of the City Council that Public Hearings on the proposed annexation of certain property should be held; now, therefore,

BE IT RESOLVED BY THE CITY COUNCIL OF THE CITY OF ABILENE, TEXAS:

PART 1: That the City Council hereby directs the Planning Division to prepare a Service Plan for the proposed annexed property, Exhibits "A" and "B", which is made a part of this resolution for all purposes.

PART 2: That this resolution shall take effect immediately from and after its passage.

ADOPTED THIS 15 day of December, A.D. 1994.

ATTEST:

CITY SECRETARY

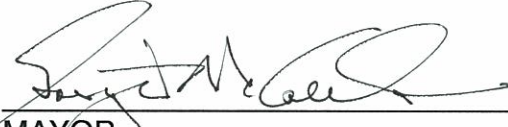
MAYOR

APPROVED:

CITY ATTORNEY

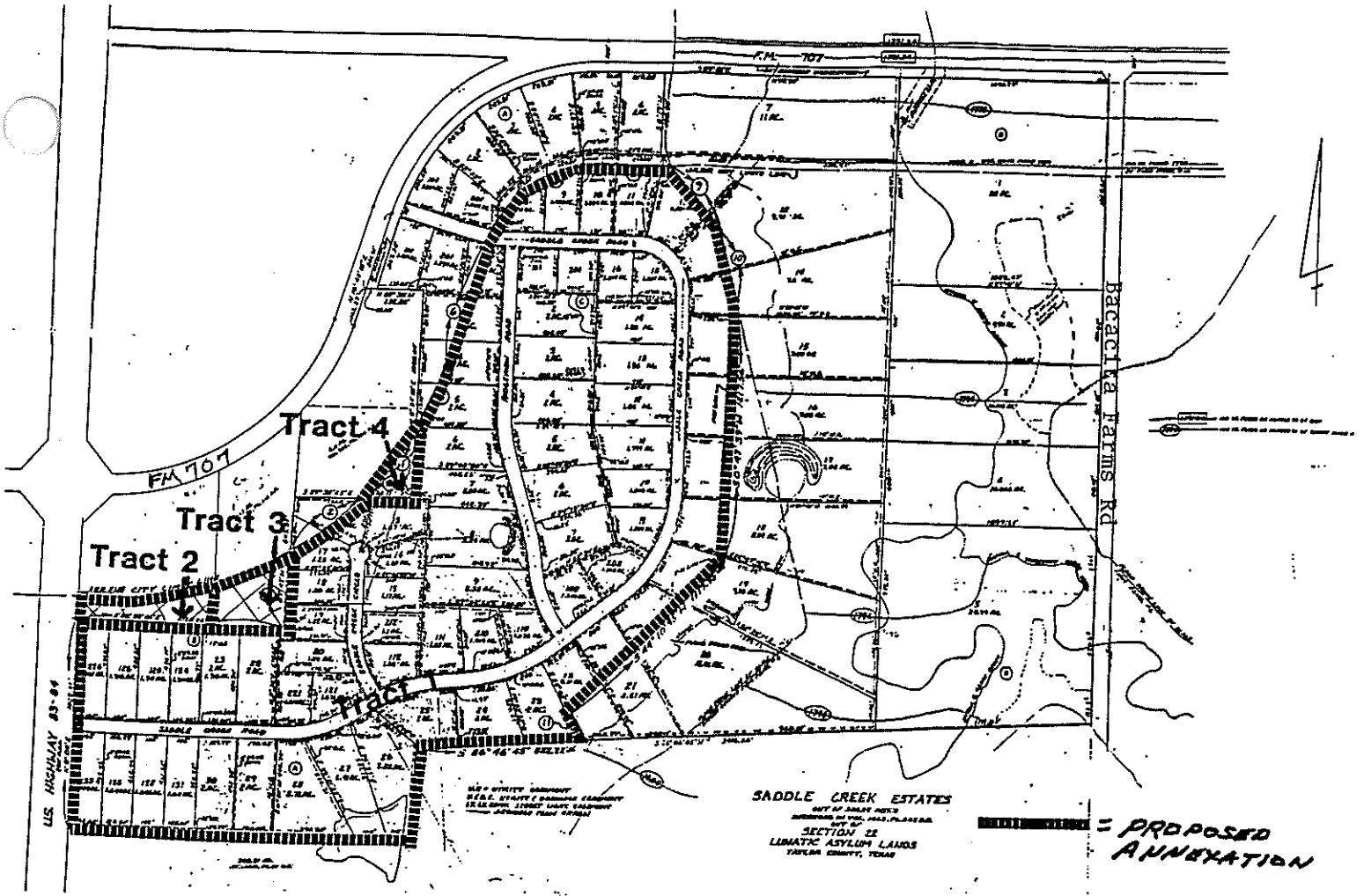

EXHIBIT "B"

STATE OF TEXAS
COUNTY OF TAYLORANNEXATION
130.66 ACRES

TRACT 1

LEGAL DESCRIPTION

BEING 130.66 acres out of a certain 306.92 acre tract, recorded in Volume 1065, Page 543, Deed Records, Taylor County, Texas, out of Section 22, Lunatic Asylum Lands, Abilene, Taylor County, Texas, and consisting of all of Section 2 & Section 3, Saddle Creek Estates, outside the city limits of Abilene, Save and Except the south part of Lots 120, 21 & 22, Block A, Section 2, Saddle Creek Estates, and all of Lots 10 & 11, Block A, and Lots 9 through 16, Block C, Section 4, and the west part of Lots 12 through 19, Block A, Section 4, to the east boundary line of the fill line, Saddle Creek Estates, and described within the metes and bounds as follows:

BEGINNING at a 1/2" iron rod by a corner post, on the east right-of-way of U.S. Highway 83-84, for the southwest corner of Lot 233, Block A, Section 2, Saddle Creek Estates, same being the southwest corner of said 306.92 acre tract and the northwest corner of a certain 368.31 acre tract.

THENCE N 0° 08' E 1022.91 feet to a 1/2" iron rod, by a corner post, for the northwest corner of Lot 226, Block B, Section 2, Saddle Creek Estates and a corner of said 306.92 acre tract;

THENCE S 88° 58' 45" E 1020.26 feet to a 3/8" iron rod, found, for a corner of said 306.92 acre tract, same being the southeast corner of a certain 7.195 acre tract;

THENCE N 1° 43' W 386.77 feet to a point on the west boundary line of Lot 17, Block B, Section 3, Saddle Creek Estates, from which the northwest corner of said Lot 17 bears N 1° 43' W 169.11 feet, said point being on the existing city limits line, and being 500 feet from the southeast right-of-way of FM 707, in a curve to the left;

THENCE along said curve to the left, having a partial delta of 14° 01' 17", a radius of 1695.92 feet, on a chord bearing of N 51° 40' 05" E 413.99 feet for an arc distance of 415.03 feet to a point on the south boundary line of a certain 6 acre tract, recorded in Volume 905, Page 326, Deed Records, Taylor County, Texas, and the north boundary line of Lot 16, Block B, Section 3, Saddle Creek Estates;

THENCE S 89° 35' 45" E 261.10 feet to a 1/2" iron rod, found, for the southeast corner of said 6 acre tract, and a corner of Lot 7, Block B, Section 2, Saddle Creek Estates;

THENCE N 0° 54' 10" E 353.42 feet to a point on the existing city limits line, in a curve to the left;

THENCE along said curve to the left, having a partial delta of 13° 00' 14", a radius of 1695.92 feet on a chord bearing of N 23° 12' 22" E 384.08 feet, for an arc distance of 384.91 feet to a point for the end of said curve, from which a concrete right-of-way marker on the east right-of-way of FM 707 bears N 73° 17' 45" W 500 feet;

THENCE N 16° 42' 15" E 567.18 feet to a point for the beginning of a curve to the right, from which a concrete right-of-way marker, on the east right-of-way of FM 707, bears N 73° 17' 45" W 500 feet;

THENCE along the existing city limits line and said curve to the right, having a central angle of 73° 36' 45", a radius of 595.73 feet, on a chord bearing of N 53° 30' 37" E 713.82 feet for an arc distance of 765.39 feet to the end of said curve, from which a 1/2" iron rod, found, for a corner of Lot 5, Block A, Section 1, Saddle Creek Estates, bears N 0° 19' E 50.00 feet and a concrete right-of-way marker on the south right-of-way of FM 707 bears N 0° 19' E 500 feet;

THENCE S 89° 41' E 334.41 feet to a point at the intersection of the existing city limits line and the fill line, shown in Lot 12, Block A, Section 4, Saddle Creek Estates;

THENCE along said fill line as follows:

S 42° 23' 38" E 419.73 feet,

S 15° 36' 02" E 381.78 feet,

S 0° 47' 39" W 1217.56 feet,

S 44° 10' 03" W 1119.95 feet to a point on the east boundary line of Lot 23, Block A, Section 2, Saddle Creek Estates;

THENCE S 28° 05' 09" E 148.83 feet to a 3/8" iron rod, found, for the southeast corner of said Lot 23, on the north boundary line of said 368.31 acre tract;

THENCE S 86° 46' 45" W 822.22 feet to a 3/8" iron rod, by a corner post, for a corner of said 368.31 acre tract and the southwest corner of Lot 25 and a corner of Lot 26, Block A, Section 2, Saddle Creek Estates, and a corner of said 306.92 acre tract;

THENCE S 2° 55' 15" W 443.97 feet to a 3/8" iron rod, found, by a corner post for a corner of said 368.31 acre tract;

THENCE N 89° 58' 15" W 1663.13 feet to the POINT OF BEGINNING, and containing 130.66 acres of land, more or less.

Certified correct as surveyed November 1994.

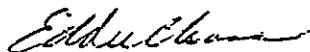

Eddie Chase

Registered Professional Land Surveyor No. 1901



County of Taylor
State of Texas

TRACT 2
ANNEXATION

Fieldnotes of a survey of 2.31 acres of land being located in Section 22 L.A.L., Taylor County, Texas. Said land is a part of that land by deed as recorded in Volume 2012, Page 95 of the Deed Records of Taylor County, Texas and being more particularly described as follows;

Beginning at the north west corner of Lot 226, Block B, Section 2, Saddle Creek Estates, and also being on the east right of way of U.S. Highway 83-84;

THENCE South 88 degrees 58 minutes 45 seconds East for a distance of 673.46 feet along the north line of said Block B, Section 2, Saddle Creek Estates to the southeast corner of said land as shown in Volume 2012, Page 95;

THENCE North 01 degrees 45 minutes 00 seconds East for a distance of 218.15 feet along the east line of said tract of land described in Volume 2012, Page 95 to the existing City Of Abilene City Limits line being 500 feet from perpendicular to the south right of way of F.M. Highway 707;

THENCE along a curve to the right having a radius of 1695.92 feet and an arc length of 568.76 feet, being subtended by a chord of South 81 degrees 24 minutes 48 seconds West for a distance of 566.10 feet along the City of Abilene city limits;

THENCE North 89 degrees 52 minutes 00 seconds West for a distance of 119.98 feet along the City of Abilene city limits to the east right of way of U. S. Highway 83-84;

THENCE South 00 degrees 08 minutes 00 seconds West for a distance of 121.81 feet along the east right of way of U. S. Highway 83-84 to the place of beginning and containing 2.31 acres more or less.

County of Taylor
State of Texas

TRACT 3
ANNEXATION

Fieldnotes of a survey of 2.34 acres of land being located in Section 22 L.A.L., Taylor County, Texas. Said land is a part of that 7.195 acre tract of land by deed as recorded in Volume 1615, Page 612 of the Deed Records of Taylor County, Texas and being more particularly described as follows;

Beginning at an interior corner of Block B, Section 3, Saddle Creek Estates, and an interior corner of Lot 19, Block B, Section 3, Saddle Creek Estates, and also being the southeast corner of said 7.195 acre tract of land;

THENCE North 01 degrees 45 minutes 00 seconds East for a distance of 386.66 feet along the east line of said 7.195 acre tract of land to the existing City of Abilene City Limits line being 500 feet from perpendicular to the south right of way of F. M. Highway 707;

THENCE along a curve to the right having a radius of 1695.92 feet and an arc length of 388.35 feet, being subtended by a chord of South 65 degrees 14 minutes 44 seconds West for a distance of 387.50 feet along the City of Abilene City Limits to the west property line of said 7.195 acre tract of land;

THENCE South 01 degrees 45 minutes 00 seconds West for a distance of 218.15 feet along the west property line of said 7.195 acre tract to the north line of Block B, Section 2, Saddle Creek Estates and the south west corner of said 7.195 acre tract of land;

THENCE South 88 degrees 58 minutes 45 seconds East for a distance of 346.80 feet to the place of beginning and containing 2.34 acres more or less.

County of Taylor
State of Texas

TRACT 4
ANNEXATION

Fieldnotes of a survey of 0.96 acre of land being located in Section 22, L.A.L., Taylor County, Texas. Said land is a part of that 6 acre tract of land described in a deed as recorded in Volume 905, Page 326 of the Deed Records of Taylor County, Texas and being more particularly described as follows;

Beginning at a point on the current City of Abilene city limits being located 500 feet southeasterly from and perpendicular to the southeasterly right of way of FM Highway 707 and also being located on the easterly line of said 6 acre tract of land and a west line of Section 2, Saddle Creek Estates;

THENCE South 00 degrees 54 minutes 10 seconds West for a distance of 353.42 feet along the east line of said 6 acre tract and the west line of Section 2, Saddle Creek Estates to the most westerly south west corner of Lot 7, Block B, Section 3, Saddle Creek Estates;

THENCE North 89 degrees 35 minutes 45 seconds West for a distance of 261.10 feet along a north line of Block B, Section 3, Saddle Creek Estates to the existing City of Abilene City Limits being located 500 feet southeasterly from and perpendicular to the southeasterly right of way of FM Highway 707 and also being located on the south line of said 6 acre tract of land;

THENCE along a curve to the left having a radius of 1695.92 feet and an arc length of 442.49 feet, being subtended by a chord of North 37 degrees 10 minutes 58 seconds East for a distance of 441.23 feet along said City of Abilene City Limits to the place of beginning and containing 0.9618 acre of land.