

RESOLUTION NO. 23-1996

A RESOLUTION OF THE CITY COUNCIL OF THE CITY OF ABILENE, TEXAS, AMENDING THE SOUTHWEST AREA LAND USE PLAN-1993.

WHEREAS, this Council has received a request to amend a portion of the Southwest Area Land Use Plan-1993, and has held a public hearing thereon and finds the proposed amendment constitutes a suitable change to the existing plan; now, therefore

BE IT RESOLVED BY THE CITY COUNCIL OF THE CITY OF ABILENE, TEXAS:

PART 1: That the document entitled Southwest Area Land Use Plan-1993 and dated September 1993 is hereby amended to allow low density commercial use for a 1.392 acre tract and high density residential use for a 12.39 acre tract, both located in the vicinity of Catclaw Drive and the extension of Rolling Green Drive, as indicated by Exhibit "A".

PART 2: That the Planning and Zoning Commission shall periodically review the Southwest Area Land Use Plan-1993 Study and recommend to the Council extensions, changes or additions to the study which the Commission considers necessary in the light of changing conditions.

PART 3: That this resolution shall take effect immediately from and after its passage.

ADOPTED THIS 11 day of July, A.D. 1996.

ATTEST:



CITY SECRETARY



MAYOR

APPROVED:



CITY ATTORNEY

Existing: Low Density Residential
 Proposed: Low Intensity Commercial

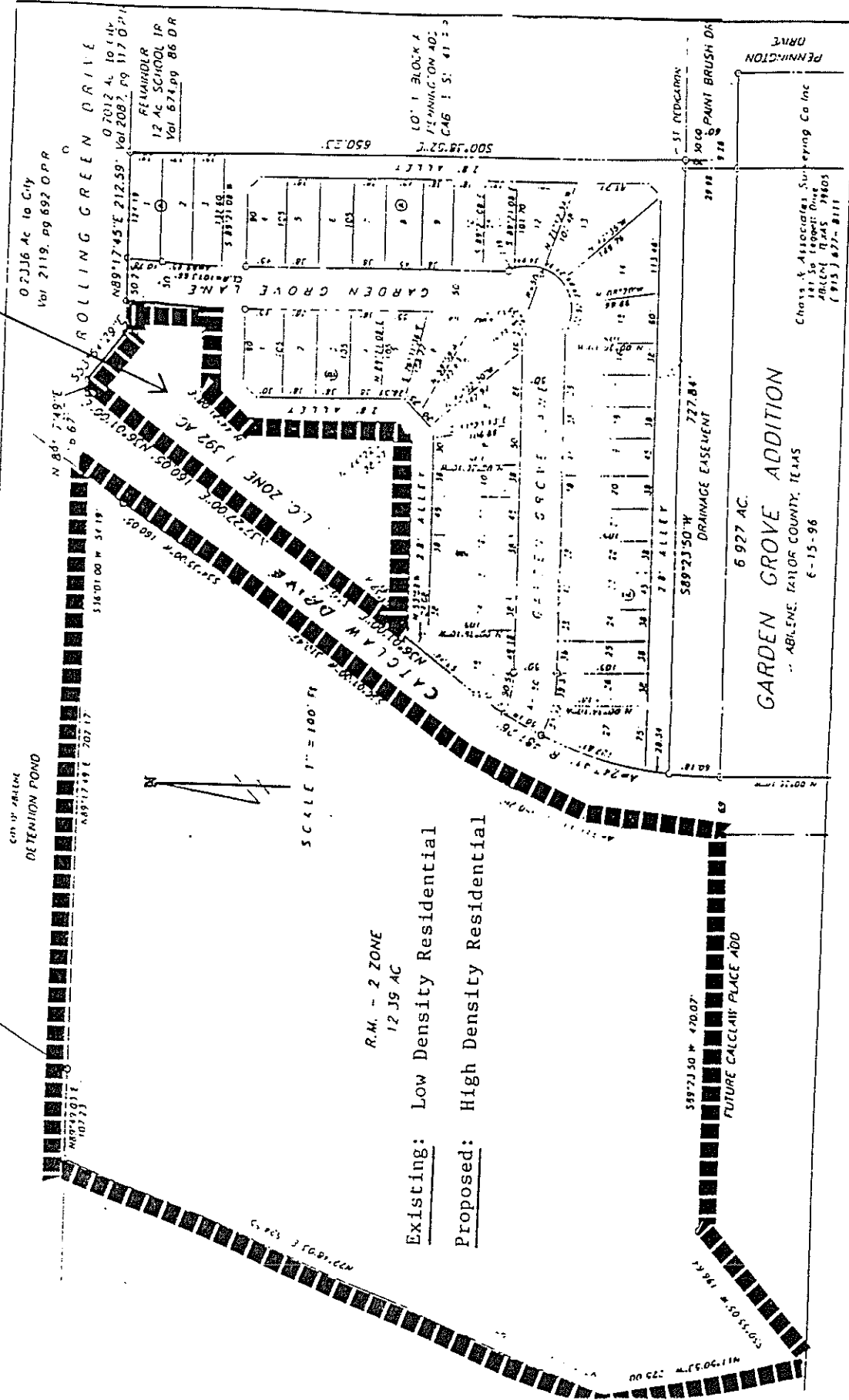

R.M. - 2 ZONE
 12 J9 AC

Existing: Low Density Residential
 Proposed: High Density Residential

GARDEN GROVE ADDITION
 6.927 AC.
 ABILENE, TARRANT COUNTY, TEXAS
 6-15-96

Choys & Associates, Surveying Co. Inc.
 4815 So. Regent Drive
 Abilene, Texas 79605
 (817) 877-8111

Existing and Proposed Land Use Categories
 Re: Southwest Area Land Use Plan - 1993