

ORDINANCE NO. 124-1981

# 20217

AN ORDINANCE PROVIDING FOR THE ABANDONMENT OF A PORTION OF PUBLIC RIGHT OF WAY; PROVIDING FOR THE TERMS AND CONDITIONS OF SUCH ABANDONMENT, AND CALLING A PUBLIC HEARING.

BE IT ORDAINED BY THE CITY COUNCIL OF THE CITY OF ABILENE, TEXAS:

PART 1: That the following described portion of a Public Right of Way, as described on Exhibit "A," attached hereto and made a part of this ordinance for all purposes, be, and the same is hereby abandoned, vacated and closed insofar as the right, title or easement of the public is concerned.

PART 2: That said portion of a Public Right of Way is not needed for public purposes and it is in the public interest of the City of Abilene to abandon said described portion of a Public Right of Way.

PART 3: That the abandonment provided for herein shall extend only to the public right, title and easement in and to the tracts of land described in Part 1 of this ordinance, and shall be construed only to that interest the governing body of the City of Abilene may legally and lawfully abandon.

PASSED ON FIRST READING this the 8 day of October, A.D. 19 81.

A notice of the time and place, where and when said ordinance would be given a public hearing and considered for final passage, was published in the Abilene Reporter-News, a daily newspaper, of general circulation in the City of Abilene, said publication being on the 4 day of October, 19 81, the same being more than twenty-four (24) hours prior to the time designated for said hearing. After such opportunity for the public to be heard, said ordinance was passed on second and final reading.

PASSED ON SECOND AND FINAL READING this the 23 day of October, A.D. 19 81.

(SEAL)  
ATTEST:

Ruth Holzgin  
CITY SECRETARY

[Signature]  
MAYOR PRO TEM

APPROVED:

[Signature]  
CITY ATTORNEY

ORDINANCE NO. 124-198

EXHIBIT "A"

Legal Description:

That portion of Energy Drive which extends south from Petroleum Drive for a distance of 205 feet.

SAVE AND EXCEPT:

Retention of a utility easement being 60 feet wide and 15 feet in length from the south right-of-way line of Petroleum Drive.

-END-

9a-7

EXHIBIT "A"

Ordinance No. 124-1981

Legal Description:

That portion of Energy Drive which extends south from Petroleum Drive for a distance of 205 feet to buttonwillow Creek being approximately 60 feet wide and filed of record on the plat of Section 3, South Treadaway & Industrial Blvd. Plaza Addition, Abilene, Taylor County, Texas, January 14, 1981.

SAVE AND EXCEPT:

Retention of a utility easement being 60 feet wide and 15 feet in length from the south right-of-way line of Petroleum Drive.

-END-

8-66

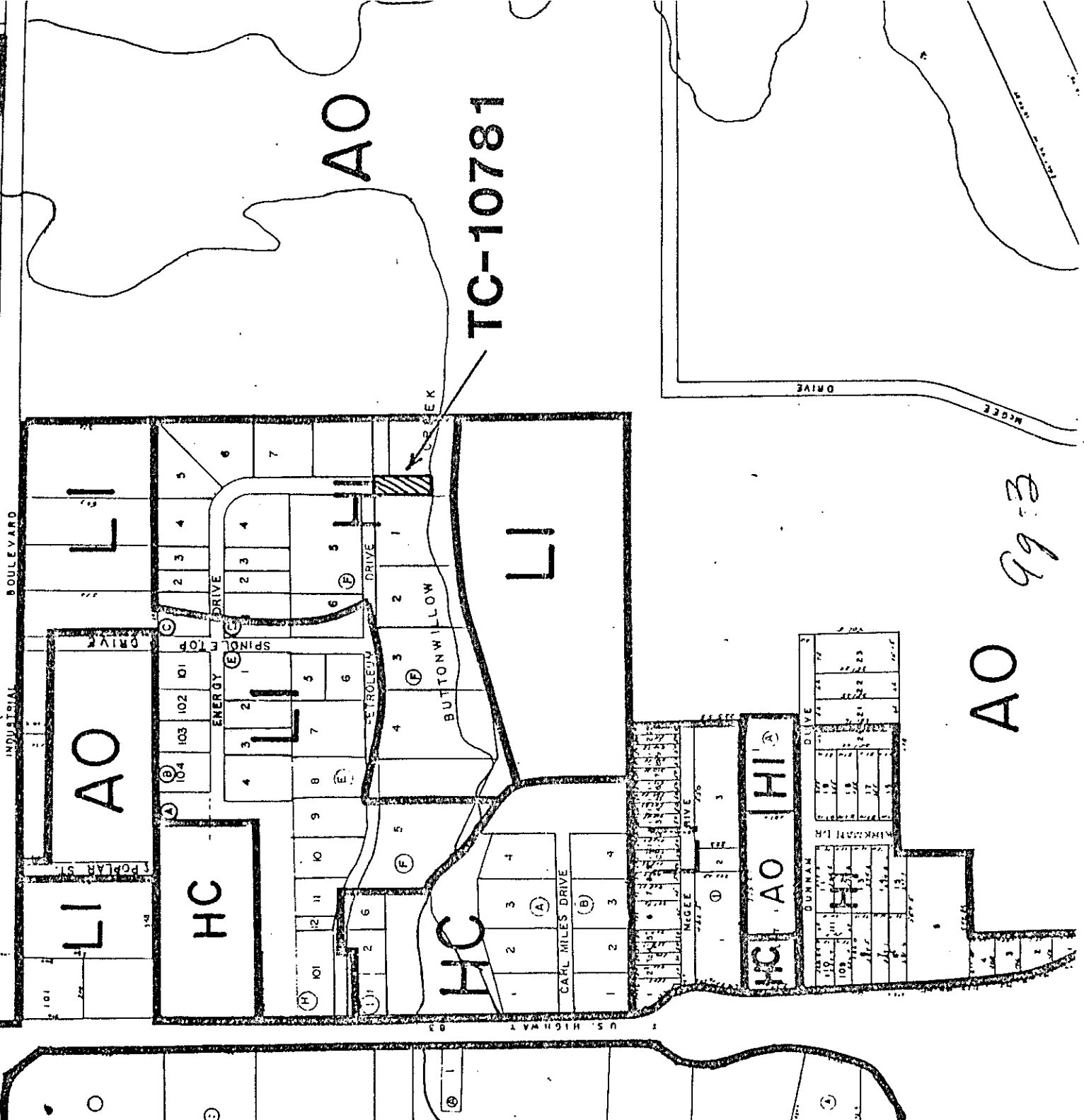

TC-10781

AO 99-3



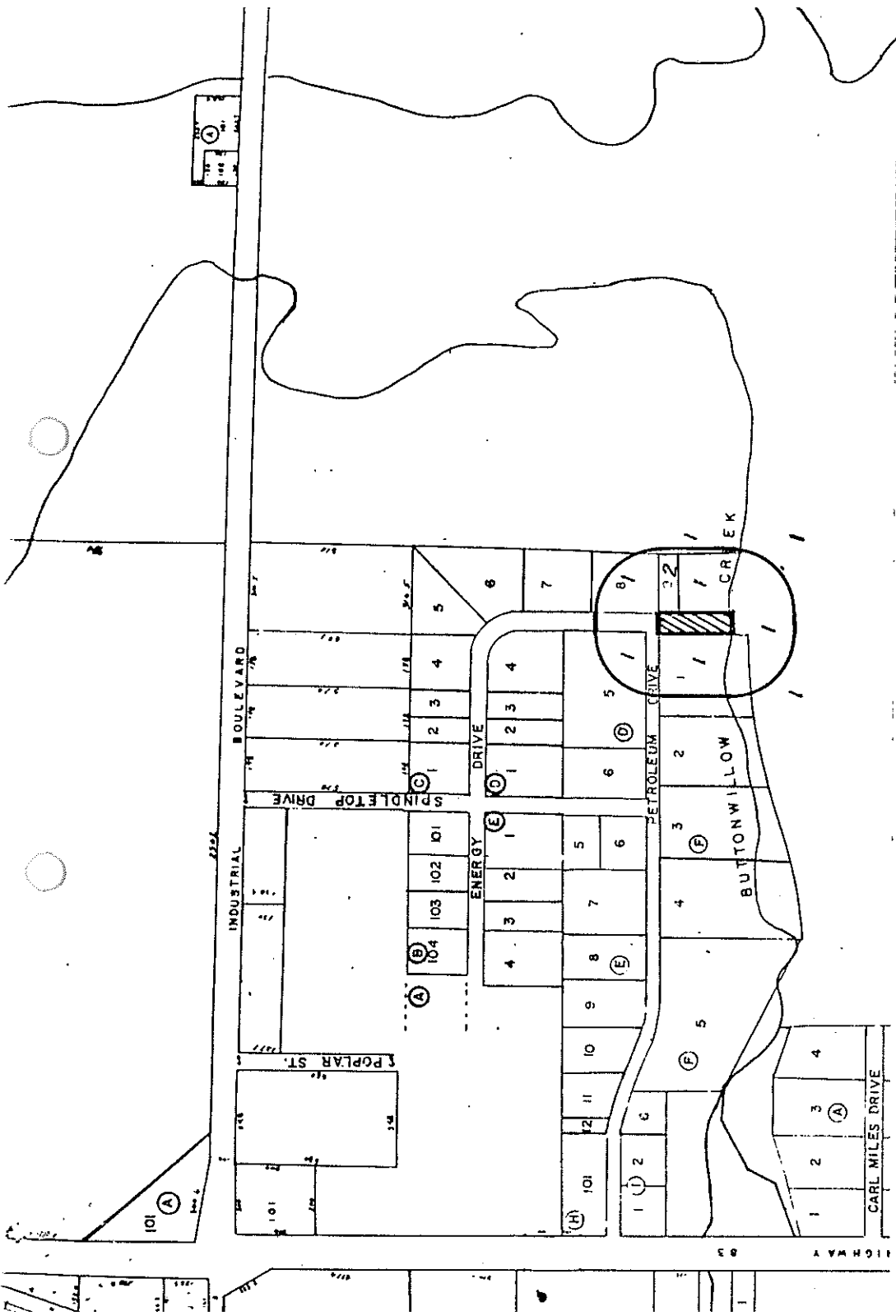

# TC-10781

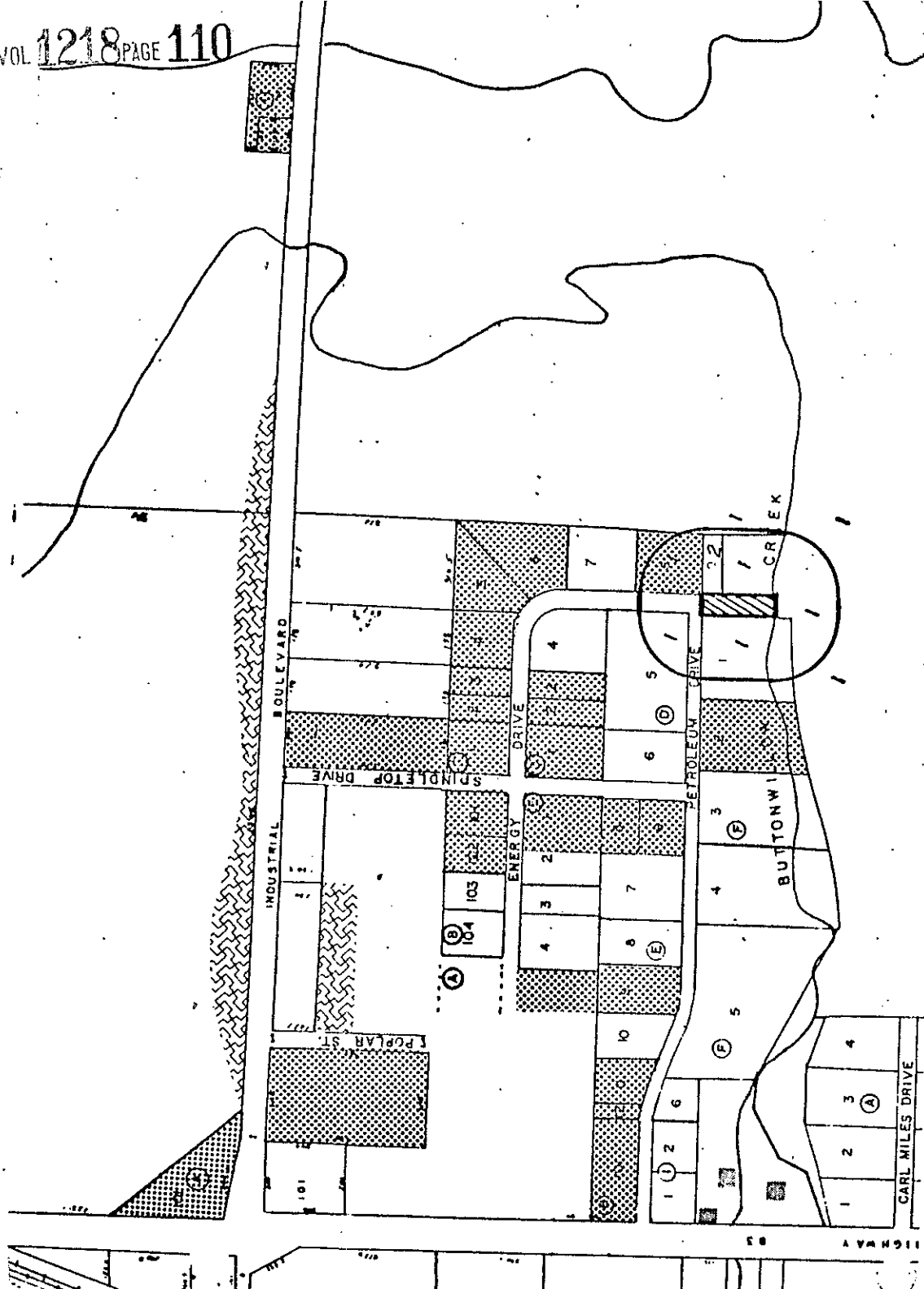

1. Proponent
2. B. V. Mealer, 3434 N. 6th, 79603

99-4



TC-10781

**LEGEND.**

-  COMMERCIAL, INDUSTRIAL
-  RESIDENTIAL
-  PUBLIC/SEMI-PUBLIC

1. Proponent
2. B. V. Mealer, 3434 N. 6th, 79603

99-5

THE STATE OF TEXAS |  
COUNTY OF TAYLOR |  
CITY OF ABILENE |

I, Ruth Hodgum, City Secretary of the City of Abilene, Texas, do hereby certify that the above and foregoing is a true and correct copy of an ordinance adopted by the City Council of the City of Abilene, Texas, on 22 day of October, A. D., 19 81, same being recorded in the Ordinance Records of the City of Abilene, Texas, Volume I, Page 410.

Given under my hand and seal of office, this the 29

day of October, A. D., 19 81.

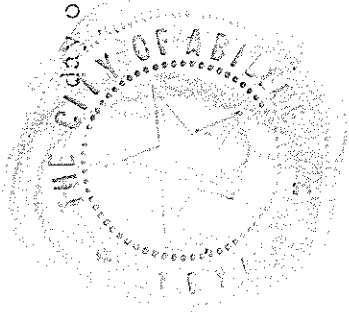

Ruth Hodgum  
City Secretary, City of Abilene, Texas