

ORDINANCE NO. 10-2025

AN ORDINANCE OF THE CITY OF ABILENE, TEXAS, AMENDING THE "LAND DEVELOPMENT CODE" OF THE ABILENE CITY CODE, BY APPROVING A CONDITIONAL USE PERMIT (CUP) AFFECTING A CERTAIN PROPERTY; CALLING A PUBLIC HEARING; PROVIDING A PENALTY AND AN EFFECTIVE DATE.

BE IT ORDAINED BY THE CITY COUNCIL OF THE CITY OF ABILENE, TEXAS:

PART 1: That Chapter 23 of the Land Development Code of the City of Abilene, is hereby amended by approving a Conditional Use Permit (CUP) as set out in Exhibit A, attached hereto and made a part of this ordinance for all purposes.

PART 2: That any person, firm or corporation violating any of the provisions of this chapter shall be deemed guilty of a misdemeanor, and upon conviction thereof, shall be punished by a fine of not more than Two Thousand Dollars (\$2,000.00). Each day such violation shall continue or be permitted to continue, shall be deemed a separate offense.

PART 3: That the Planning Director be, and is hereby authorized and directed to change the official Zoning Map of the City of Abilene to correctly reflect the amendments thereto.

PASSED ON FIRST READING the 23rd day of January, 2025.

A notice of the time and place, where and when said ordinance would be given a public hearing and considered for final passage, was published in the *Abilene Reporter-News*, a daily newspaper of general circulation in the City of Abilene, said publication being on the 20th day of December, 2024, the same being more than fifteen (15) days prior to a public hearing held in the Council Chamber of the City Hall in Abilene, Texas, at 8:30 a.m. on the 13th day of February, 2025, to permit the public to be heard prior to final consideration of this ordinance. Said ordinance, being a penal ordinance, becomes effective ten (10) days after its publication in the newspaper, as provided by Section 19 of the Charter of the City of Abilene.

PASSED ON FINAL READING THIS 13th day of February, 2025.

ATTEST:

CITY SECRETARY

MAYOR

APPROVED.

CITY ATTORNEY

EXHIBIT B

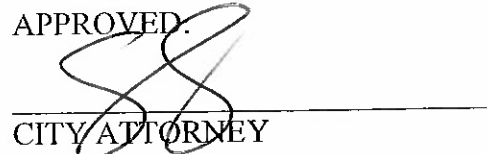
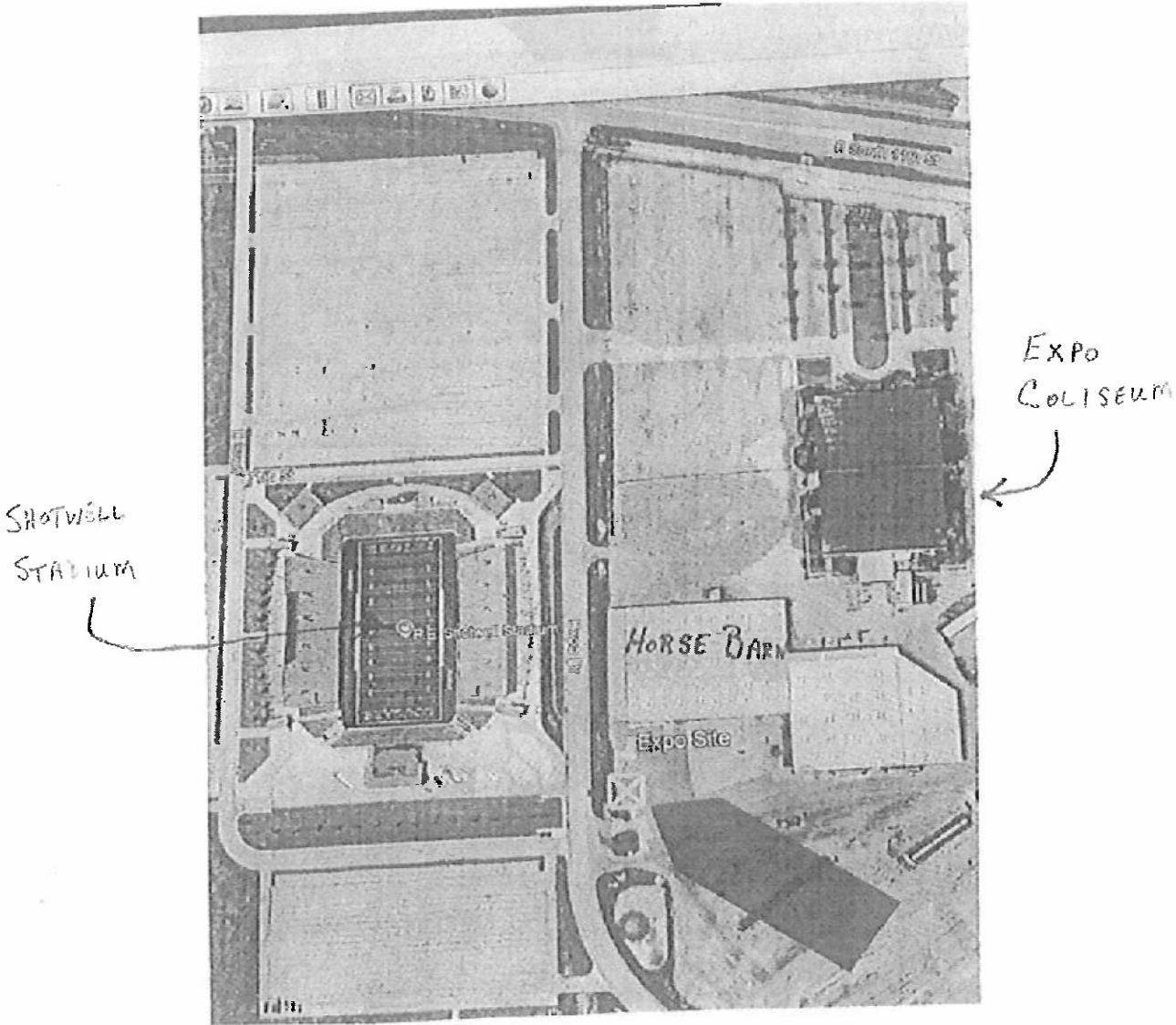
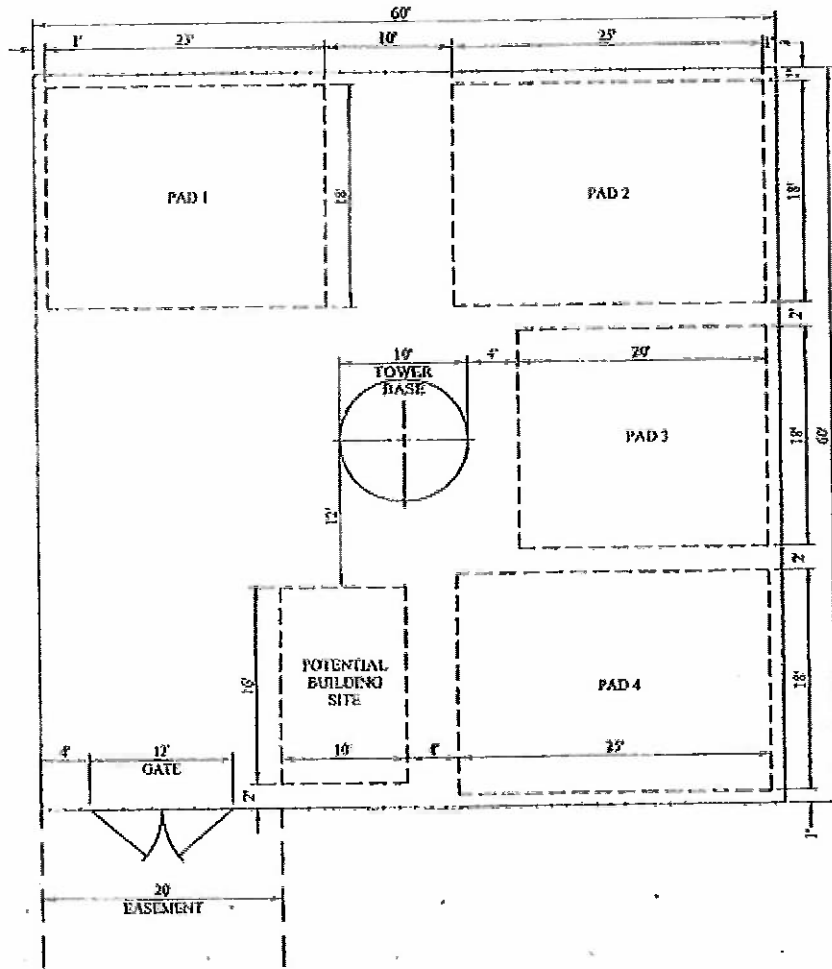

EXHIBIT C

(2) Site Plan



5 0 10
SCALE IN FEET

END